

Product Overview

Usually, timing pulleys and timing belts are widely used to design mechanisms for transmitting rotational power generated by motors. Driving and transmission are realized through the engagement between the teeth of timing pulleys and timing belts.

Dimensional Drawing

Standard Tooth Profile

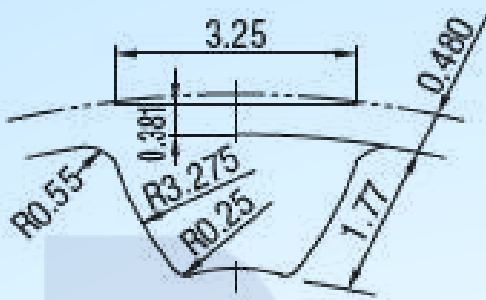

Pulley Shape A

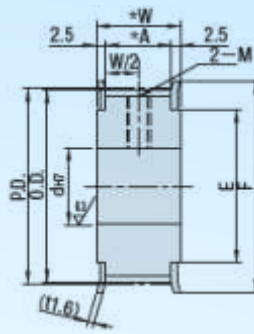

Pulley Shape B

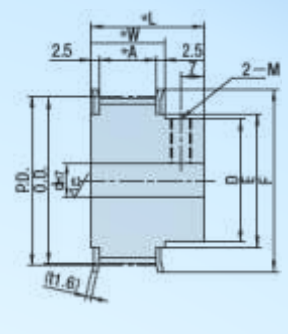

The tooth groove size varies slightly with the number of teeth (Tooth pitch: 5.0 mm)

The tooth groove size varies slightly with the number of teeth (Tooth pitch: 5.0 mm)

Shaft Bore Specs.

H Round Hole

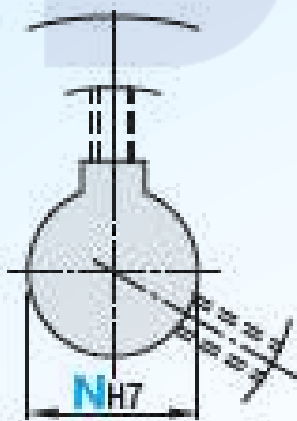

P Round Hole + Threaded Hole

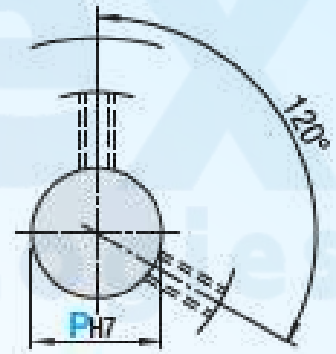

Without threaded holes.

The stop threaded hole of Shape A pulley is located near 120° to avoid interference with the threads.

Without Threaded Holes.	M	Accessory
Shaft Bore ID	(Coarse Thread)	(Fixing Screw)
5	M3	M3×3
6~12	M4	M4×3
13~17	M5	M5×4
18~30	M6	M6×5
31~45	M8	M8×6
46~65	M10	M10×8



Part Number			Material		Surface Treatment
Belt Width 10mm	Belt Width 15mm	Belt Width 25mm	Pulley	Flange	
A: 11 W: 16 L: 28	A: 17 W: 22 L: 34	A: 27 W: 32 L: 44	Aluminum Alloy	Aluminum Alloy	Clear Anodized
DE-HTPA S5M100	DE-HTPA S5M150	DE-HTPA S5M250			Black Anodized
DE-HTPB S5M100	DE-HTPB S5M150	DE-HTPB S5M250			Hard Clear Anodize *
DE-HTPK S5M100	DE-HTPK S5M150	DE-HTPK S5M250			Black Oxide Coating
DE-HTPM S5M100	DE-HTPM S5M150	DE-HTPM S5M250	Equivalent to S45C	SPCC	Electroless Nickel Plating
DE-HTPP S5M100	DE-HTPP S5M150	DE-HTPP S5M250			SUS304 Equivalent
DE-HTPS S5M100	DE-HTPS S5M150	—	SUS304 Equivalent		—

Part Number			Pulley Shape	Shaft Bore	H		P		N		P.D.	O.D.	D	F	E
Type	Number of Teeth	Type & Nominal Width			Round Hole		Round Hole + Threaded Hole		Keyway Hole + Tap						
					Shape A	Shape B	Shape A	Shape B	Shape A	Shape B					
(Aluminum Alloy) DE-HTPA DE-HTPB DE-HTPK	14	S5M100 *A : 11 *W : 16 *L : 28	A	H	5~12	5~10	5~10	5~8	8?10?NK10	—	22.28	21.32	14	26	16
	15				5~14	5~11	5~10	5~8	8?10?NK10	—	23.87	22.91	15	28	18
	16				5~16	5~13	5~12	5~10	8~12	8	25.46	24.5	17	32	20
	18				6~18	6~15	6~12	6~11	8~12	8•10•NK10	28.65	27.69	19	33	22
	19				6~20	6~15	6~16	6~11	8~16	8•10•NK10	30.24	29.28		36	24
	20				6~20	6~15	6~16	6~11	8~16	8•10•NK10	31.83	30.87	19	36	24
	22				7~23	7~20	7~18	7~16	8~18	8~12	35.01	34.05	24	40	27
	24				7~26	7~23	7~20	7~17	8~20	8~13	38.2	37.24	27	45	30
	25				7~26	7~23	7~20	7~17	8~20	8~15	39.79	38.83		48	35
	26				8~31	8~27	8~23	8~21	8~22	8~17	41.38	40.42	31	48	35
(S45C equivalent) DE-HTPM DE-HTPP	28	S5M150 *A : 17 *W : 22 *L : 34	B	P	8~31	8~28	8~24	8~22	8~24	8~18	44.56	43.6	32	52	36
30	10~32	10~29			10~26	10~23	10~26	10~18	47.75	46.79	33	55	40		
(SUS304 equivalent) DE-HTPS	32	S5M250 *A : 27 *W : 32 *L : 44	N	N	10~36	10~33	10~28	10~27	10~28	10~22	50.93	49.97	37	61	45
34	10~41				10~36	10~33	10~30	10~33	10~25	54.11	53.15	40	61	45	
36	10~41				10~36	10~33	10~30	10~33	10~25	57.3	56.34		47	67	50
40	10~46				10~43	10~38	10~35	10~38	10~28	63.66	62.7	47	67	50	
44	12~54				12~46	12~42	12~38	12~40	12~32	70.03	69.07	50	74	58	
48	12~59				12~56	12~45	12~45	12~40	12~40	76.39	75.43	60	83	63	
50	12~63				12~59	12~50	12~47	12~43	12~43	79.58	78.62	63	87	67	
60	12~76				12~71	12~50	12~50	12~50	12~50	95.49	94.53	75	99	80	
72	12~85				12~80	12~70	12~70	12~55	12~55	114.59	113.63	90	119	100	

- ① The number of teeth for DHTPS is limited to values marked with *.
- ② Z-d≥2 for Shaft Bore Specs. V or F.
- ③ Q(R)-d≥2 for Shaft Bore Specs. Y.
- ④ Shaft Bore Dia. 4.5 and 6.35, if falling within the selection range, can be selected for Shaft Bore Specs. H, P, V and F.
- ⑤ Specify NK10 when New JIS Keyway Hole + Threaded Hole with shaft bore diameter of 10 and keyway width 4.0mm (height 1.8mm) is requested. Here
- ⑥ NK10, if falling within the selection range, can also be selected for Shaft Bore Specs. N.
- ⊗ Shaft Bore Dia. 8, 9, 11, 13, 14, 17 and 21~55 are not available for Shaft Bore Specs. C.
- ⊗ Shaft Bore Dia. 9 and 51~54 are not available for Shaft Bore Specs. N.

Basic Specifications

- Type - Timing Pulleys
- Belt Type - S5M

