

Product Overview

Economy series Welded butterfly Flat Hinges for heavy object

Flat Hinges, This series of products are butterfly Flat Hinges for heavy objects, which can reach an allowable load of up to 90KG depending on the dimensions (the value when using 2 pcs)
The product is made of stainless steel, and there is no hole in the product body. It is fixed to the object by welding. The fixed object must be kept flat and clean to avoid poor welding.



● Economy series For heavy object Butterfly Flat Hinges Welded type



● Economy series For heavy object Butterfly Flat Hinges Welded type (Side view)

● Dimensional Drawing

Economy series Welded butterfly Flat Hinges for heavy object Dimensional drawing
Refer to the Specification Table below for detailed product dimensions

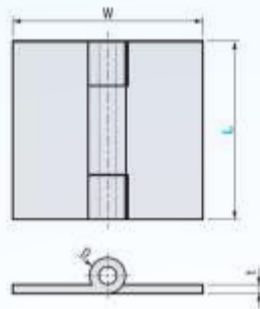

Material Table

Product Material, Surface Treatment Overview :

● Flat Hinges Material Table

Type	Material	Surface Treatment
DC-HHSYZN	SUS304	Fog pearlescent grinding

Part Number		W	R	t	*Allowable Load (N)
Type	L				
DC-HHSYZN	50	50	6	3	196
	60	60			245
	75	75			294
	100	100	10	4	588
	125	125			686
	150	150			882

● * The allowable load is the value when 2 pieces are used.

● Product Features

【Features】

Butterfly Flat Hinges for heavy objects can achieve high allowable loads, and when used with high-hardness bolts, they can reach a load capacity of up to 90KG (the value when using 2 pcs).

It is recommended to use only two products for each door.

Multiple products cannot achieve the effect of increasing the load.

At the same time,

multiple hinges will cause other interference problems caused by insufficient center-axis straightness of the hinge.

Precautions

The flat head bolt type and the ultra-low head bolt type have the same product specifications, only the mounting holes are different.

Please refer to the Specification Table for details.

Butterfly Flat Hinges can't increase the allowable load by adding more products.

On the contrary, during installation, it is easy to cause eccentric load due to the fact that three center axes can not be on the same horizontal line at the same time.

It is easy for the door panel to be in a non-displacement state when standing still.

Example of Use

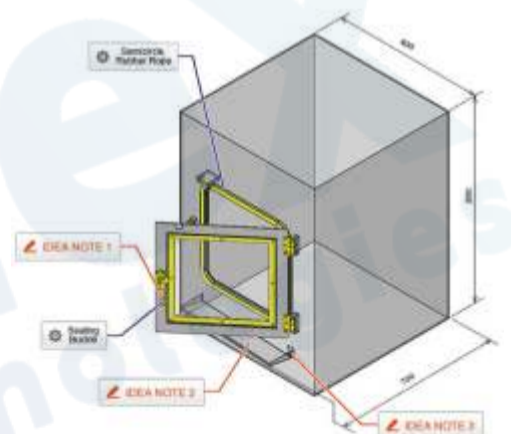

Butterfly Flat Hinges for heavy object Example of use

● Basic Specifications

- Flat Hinge Type - Square Plate Type
- Mounting Method - Weld-On

- Main Body Type - Flag Hinge
- Additional Function - Not Provided

- Operating Environment - Standard

