

# Bushings For Locating Pins - Straight, Press Fit for Easy Mounting

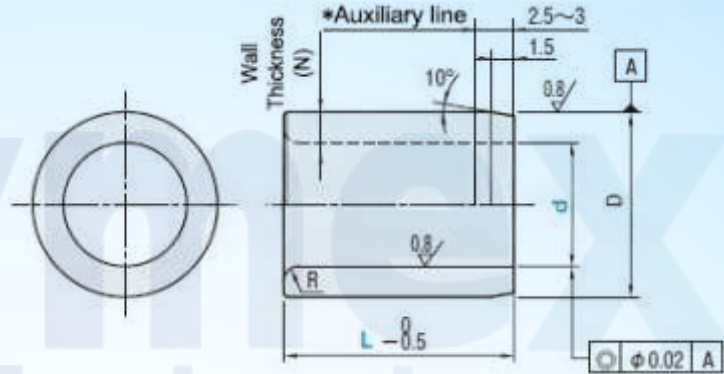

Material No.	Type		M	S	H
	D <sub>p7</sub>	D <sub>m7</sub>	Material	Surface Treatment	Hardness
(1)	DC-JBA	DC-JBAM	Equivalent to SUJ2	—	58 HRC or more
(2)	DC-JBAN	DC-JBAMN	Equivalent to SUJ2	Electroless Nickel Plating	58 HRC or more
(3)	DC-JBAC	DC-JBAMC	Austenitic stainless steel	—	—

For hole machining, please note that inner diameter shrinkage of p6 Type is more than that of m6 Type.

Type	Type	Inner Diameter d	d Tolerance F7	L Selection						Wall Thickness (N)	R	Outer Diameter D	D Tolerance	
				p <sub>7</sub>	m <sub>7</sub>									
(p7) DC-JBA DC-JBAN DC-JBAC	2	+0.016	5 6 7 8 10 12	0.8	5	+0.024	+0.016	1.5	0.8	7	+0.012	+0.004		
	3	+0.006	5 6 7 8 10 12			+0.012	+0.004							
	4	+0.022 +0.010	5 6 7 8 10 12 15 16 20	1	8	+0.030	+0.021	2	1	10	+0.015	+0.006		
	5		5 6 7 8 10 12 15 16 20 25			+0.015	+0.006							
	(m7) DC-JBAM DC-JBAMN DC-JBAMC	6	+0.028 +0.013	5 6 7 8 10 12 15 16 20 25	2	12	+0.036	+0.025	2.5	2	12	+0.018	+0.007	
		8		5 6 7 8 10 12 15 16 20 25 30			+0.018	+0.007						
10		+0.034 +0.016	6 7 8 10 12 15 16 20 25 30	2	15	+0.043	+0.029	3	2	15	+0.022	+0.008		
12			8 10 12 15 16 20 25 30			+0.022	+0.008							
13		+0.041 +0.020	10 12 15 16 20 25 30	3	18	+0.051	+0.034	5	3	18	+0.026	+0.009		
15			12 15 16 20 25 30			+0.026	+0.009							
16		+0.041 +0.020	12 15 16 20 25 30	3	22	+0.051	+0.034	5	3	22	+0.026	+0.009		
20			12 15 16 20 25 30			+0.026	+0.009							
25	+0.041 +0.020	12 15 16 20 25 30	3	26	+0.051	+0.034	5	3	26	+0.026	+0.009			
25		16 20 25 30 35			+0.026	+0.009								

- Compared to the m7 type, the p7 type has greater inner diameter shrinkage, so please pay attention during hole machining.
- The inner diameter tolerance of the bushing is highly precise. If a vernier caliper is used for measurement, the result may be smaller than the actual value. It is recommended to use high-precision measuring instruments (such as an inside micrometer or plug gauge) for inspection.
- Some specifications and models may be incomplete. Thank you for your understanding!

## Basic Specification

- Basic Shape - Straight
- Type - Bushing
- Fixing Support - Not Provided
- I.D. Shape - Circular

■ Auxiliary Line

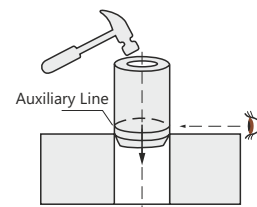

Bushings with guide lines provide effective horizontal reference and facilitate installation.

Example

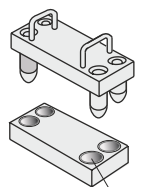

Economic Clamp Bushing DC-JBAM

