

Post-Assembly Insertion Nuts / Stoppers for Aluminum Extrusions - Standard For 8 Series (Slot Width 10mm)

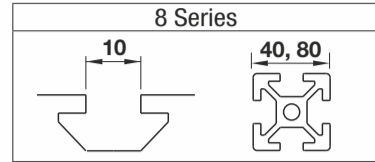

Post-Assembly Insertion Stopper Nuts

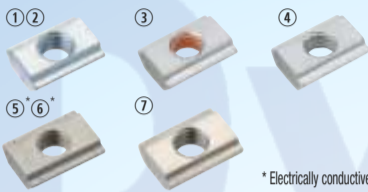

*Electrically conductive

Type	M	Material	S Surface Treatment
1 DHNTA8	S10C Equivalent	-	Trivalent Chromate
2 PACK-DHNTA8			
3 DHNTAV8			
4 DHNTAZ8			
5 DHNTASN8*	SUS316 Equivalent (Sintered)	-	-
6 PACK-DHNTASN8*	SUS316 Equivalent (Sintered)	-	-
7 DHNTASS8	SUS303 Equivalent	-	-

DHNTA8 (S10C Equivalent)
PACK-DHNTA8 (S10C Equivalent, 100/pkg.)
DHNTAV8 (Thread Locking Adhesive Type, S10C Equivalent)
DHNTAZ8 (Thread Locking Resin Coating Type, S10C Equivalent)
DHNTASN8 (SUS316 Equivalent, Sintered)
PACK-DHNTASN8 (SUS316 Equivalent, Sintered, 100/pkg.)
DHNTASS8 (SUS303 Equivalent)

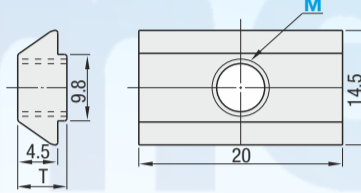

Reference Tightening Torque (N·m)

M	S10C Equivalent / SUS316 Equivalent (Sintered) / SUS303 Equivalent
8	23.5

Example

- Post-Assembly Insertion Stopper Nuts

DHNTA
DHNTAV
DHNTAZ
DHNTASN
DHNTASS

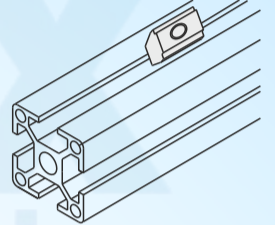

Part Number	M	T
DHNTA8 (S10C Equivalent)	4 5 6	6.5
DHNTAV8 (Thread Locking, S10C Equivalent)	8	
DHNTAZ8 (Thread Locking, S10C Equivalent)	8	
DHNTASN8 (SUS316 Equivalent, Sintered)	4 5 6 8	6.0
DHNTASS8 (SUS303 Equivalent)	8	6.5

Bulk Packages

100 pcs. per package

Part Number	M
PACK-DHNTA8 (S10C Equivalent)	4 5 6
	8
PACK-DHNTASN8 (SUS316 Equivalent, Sintered)	4 5 6 8

ORDERING GUIDE



DHNTA - 8

Post-Assembly Insertion Stoppers



Type	M	Material
1 DHNA8T8	-	Polypropylene
2 DHNB8T8	-	SUS301

DHNA8T8 (Polypropylene)
DHNB8T8 (SUS301)

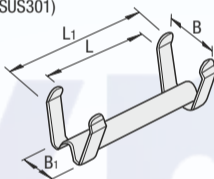

Part Number	Applicable Stopper Nut	Color	L	B	L1	B1
DHNA8T8	DHNTA8 DHNTAV8 DHNTAZ8	White	21	11.1	26	9.8
DHNB8T8	DHNTASN8 DHNTASS8	-	23	12.5	28	8

Post-Assembly Insertion Nut and Stopper Set



DHNTA8T8 (S10C Equivalent Set)
DHNTASN8T8 (SUS316 Equivalent Set)

Type	Ⓑ Stopper Nut	Ⓐ Stopper
HNTA8T8	HNTA8	HNA8T8
HNTASN8T8*	HNTASN8	HNA8T8

*Electrically conductive

Part Number	M
DHNTA8T8	4 5 6
	8
DHNTASN8T8	4 5 6 8

ORDERING GUIDE



DHNA8T8
DHTA8T8 - 8

Post-Assembly Insertion Nut and Metal Stopper Set



DHNTB8T8 (S10C Equivalent Set)
DHNTB8T8S8 (SUS316 Equivalent Set)

Type	Ⓑ Stopper Nut	Ⓐ Stopper
DHNTB8T8	DHNTA8	DHNB8T8
DHNTB8T8S8*	DHNTASN8	DHNB8T8

*Electrically conductive

Part Number	M
DHNTB8T8	4 5 6
	8
DHNTB8T8S8	4 5 6 8

ORDERING GUIDE



DHNTB8
DHTB8T8 - 8

Post-Assembly Insertion Nuts

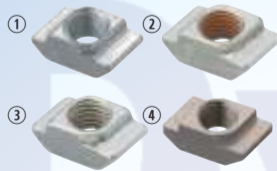

*Electrically conductive

Type	M	Material	S Surface Treatment
1 DHNTF8	S10C Equivalent	-	Trivalent Chromate
2 DHNTFV8			
3 DHNTFZ8			
4 DHNTF8S8*	SUS316 Equivalent (Sintered)	-	-

DHNTF8 (S10C Equivalent)
DHNTFV8 (Thread Locking Adhesive Type, S10C Equivalent)
DHNTFZ8 (Thread Locking Resin Coating Type, S10C Equivalent)
DHNTF8S8 (SUS316 Equivalent, Sintered)

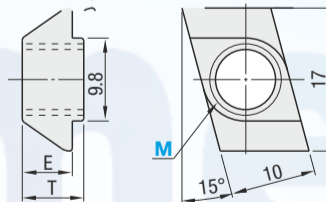

Reference Tightening Torque (N·m)

M	S10C Equivalent / SUS316 Equivalent (Sintered)
8	23.5

Example

- Post-Assembly Insertion Nuts

HNTF
HNTFV
HNTFZ
HNTF8S

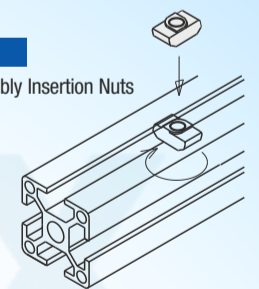

Part Number	M	E	T
DHNTF8 (S10C Equivalent)	4 5 6 8	6.0	9.0
DHNTFV8 (Thread Locking, S10C Equivalent)	8		
DHNTFZ8 (Thread Locking, S10C Equivalent)	8		
DHNTF8S8 (SUS316 Equivalent, Sintered)	4 5 6 8	6.4	8.9

ORDERING GUIDE



DHNTF8 - 8

Basic Specifications

- Nut Type - Post-Assembly Insertion Nuts
- Type - HFS

- Series - MISUMI 8 Series / MISUMI 8-45 Series

- Function - Standard

