

Rigid Couplings - Split

The rigid type cannot tolerate any lateral and angular misalignments. Adequate centering is required before use.

Split

DCPSR (Aluminum)
DCPSRS (Stainless Steel)

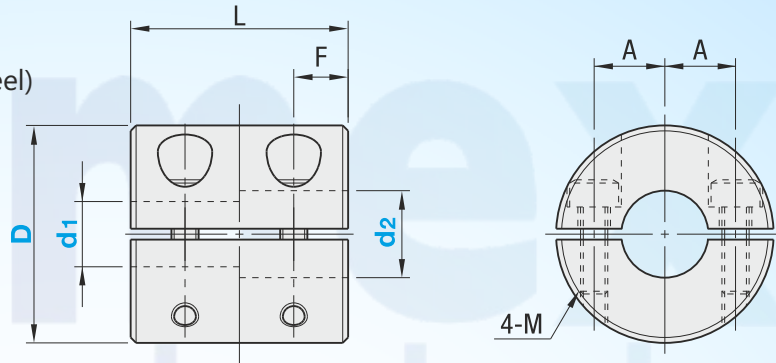

| Type | M | Material | S | Surface Treatment | A | Accessory |
|--------|---|-----------------|---|-------------------|---|---------------------------|
| DCPSR | | Aluminum Alloy | | Clear Anodize | | Hex Socket Head Cap Screw |
| DCPSRS | | Stainless Steel | | — | | |

For the selection criteria and alignment procedures

| Part Number | | d1, d2 Selection (d1 ≤ d2) | | | | L | F | A | M |
|-----------------------------|----|----------------------------|----|-------|----|------|-----|------|---|
| Type | D | | | | | | | | |
| DCPSR (Aluminum) | 16 | 5 | 6 | | 16 | 3.75 | 5 | M2.5 | |
| | 20 | 6 | 8 | | 20 | 4.75 | 6.5 | | |
| DCPSRS (Stainless Steel) | 25 | | 8 | 10 | 25 | 6 | 9 | M3 | |
| | 32 | | 10 | 12 14 | 32 | 7.75 | 11 | M4 | |

| Part Number | | Number Allowable Torque (N · m) | Max. Rotational Speed (r/min) | Moment of Inertia (kg · m ²) | Screw Tightening Torque (N · m) | Mass (g) |
|-----------------------------|----|---------------------------------|-------------------------------|--|---------------------------------|----------|
| Type | D | | | | | |
| DCPSR (Aluminum) | 16 | 0.3 | 39000 | 3.2x10 ⁻⁷ | 1 | 8.8 |
| | 20 | 0.5 | 31000 | 8.7x10 ⁻⁷ | | 15 |
| | 25 | 1 | 25000 | 2.7x10 ⁻⁶ | 1.5 | 29 |
| | 32 | 2 | 19000 | 9.3x10 ⁻⁶ | 2.5 | 61 |
| DCPSRS (Stainless Steel) | 16 | 0.3 | 39000 | 8.2x10 ⁻⁷ | 1 | 22 |
| | 20 | 0.5 | 31000 | 2.4x10 ⁻⁶ | | 41 |
| | 25 | 1 | 25000 | 7.3x10 ⁻⁶ | 1.5 | 80 |
| | 32 | 2 | 19000 | 2.5x10 ⁻⁵ | 2.5 | 160 |

Basic Specifications

- Application - Standard
- Features - High Torsional Rigidity / Zero Backlash / Low Moment of Inertia
- Max. Rotational Speed Range (r/min)- 10001~78000

ORDERING GUIDE

