

#500SP1 SL1 Wear Plate, General-Purpose Type (DSWP)



Please select the Parts No. based on the applicable width and length.

(Example) Width 75mm, length 200mm **DSWP - 75200**

Parts No. Please give instructions.

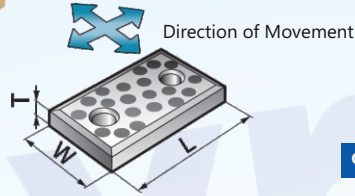

The direction of movement is both width and length.

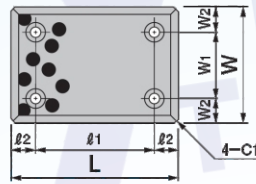
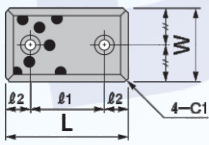

Cross-sectional shape

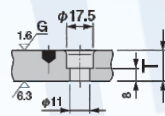

Chamfered shape

Type A

Type B

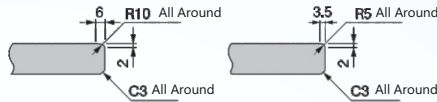

DSL P Example of use in combination with

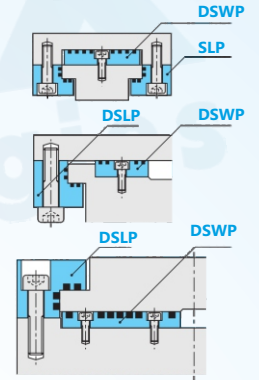

Part No.	W	Tolerance	L	Tolerance	T	Tolerance	W1	Tolerance	W2	ℓ1	Tolerance	ℓ2	Kinds	Number of Pieces	Chamfering shape
DSWP-4875	48	-0.1 -0.3	75	-0.1 -0.3	20	±0.025	—	—	—	45	±0.2	15	M10 Hexagonal Socket	2	B
DSWP-48100	48	-0.1 -0.3	100	-0.1 -0.3	20	±0.025	—	—	—	50	±0.2	25	M10 Hexagonal Socket	2	B
DSWP-48125	48	-0.1 -0.3	125	-0.1 -0.3	20	±0.025	—	—	—	75	±0.2	25	M10 Hexagonal Socket	2	B
DSWP-48150	48	-0.1 -0.3	150	-0.1 -0.3	20	±0.025	—	—	—	100	±0.2	25	M10 Hexagonal Socket	2	B
DSWP-7575B	75	-0.1 -0.3	75	-0.1 -0.3	20	±0.025	—	—	—	25	±0.2	25	M10 Hexagonal Socket	2	A
DSWP-75100B	75	-0.1 -0.3	100	-0.1 -0.3	20	±0.025	—	—	—	50	±0.2	25	M10 Hexagonal Socket	2	A
DSWP-75125	75	-0.1 -0.3	125	-0.1 -0.3	20	±0.025	—	—	—	75	±0.2	25	M10 Hexagonal Socket	2	A
DSWP-75150	75	-0.1 -0.3	150	-0.1 -0.3	20	±0.025	—	—	—	100	±0.2	25	M10 Hexagonal Socket	2	A
DSWP-75200	75	-0.1 -0.3	200	-0.1 -0.3	20	±0.025	—	—	—	150	±0.2	25	M10 Hexagonal Socket	2	A
DSWP-100100	100	-0.1 -0.3	100	-0.1 -0.3	20	±0.025	50	±0.2	25	50	±0.2	25	M10 Hexagonal Socket	4	A
DSWP-100125	100	-0.1 -0.3	125	-0.1 -0.3	20	±0.025	50	±0.2	25	75	±0.2	25	M10 Hexagonal Socket	4	A
DSWP-100150	100	-0.1 -0.3	150	-0.1 -0.3	20	±0.025	50	±0.2	25	100	±0.2	25	M10 Hexagonal Socket	4	A
DSWP-100200	100	-0.1 -0.3	200	-0.1 -0.3	20	±0.025	50	±0.2	25	150	±0.2	25	M10 Hexagonal Socket	4	A
DSWP-100250	100	-0.1 -0.3	250	-0.1 -0.3	20	±0.025	50	±0.2	25	200	±0.2	25	M10 Hexagonal Socket	4	A
DSWP-125150	125	-0.1 -0.3	150	-0.1 -0.3	20	±0.025	50	±0.2	37.5	100	±0.2	25	M10 Hexagonal Socket	4	A
DSWP-125200	125	-0.1 -0.3	200	-0.1 -0.3	20	±0.025	50	±0.2	37.5	150	±0.2	25	M10 Hexagonal Socket	4	A
DSWP-125250	125	-0.1 -0.3	250	-0.1 -0.3	20	±0.025	50	±0.2	37.5	200	±0.2	25	M10 Hexagonal Socket	4	A
DSWP-150150	150	-0.1 -0.3	150	-0.1 -0.3	20	±0.025	100	±0.2	25	100	±0.2	25	M10 Hexagonal Socket	4	A
DSWP-150200	150	-0.1 -0.3	200	-0.1 -0.3	20	±0.025	100	±0.2	25	150	±0.2	25	M10 Hexagonal Socket	4	A
DSWP-150250	150	-0.1 -0.3	250	-0.1 -0.3	20	±0.025	100	±0.2	25	200	±0.2	25	M10 Hexagonal Socket	4	A

Basic Specifications

- Material - Metal system
- Thickness T (mm) - 20
- Maximum Allowable PV Value (N/mm²-m/s) - 1.65
- Metal system material - High tensile brass based / solid lubricant embedded
- Maximum Allowable Surface Pressure P (N/mm²) - 29
- Lubrication - Non-Lubricated
- Maximum Allowable Velocity V (m/s) - 0.5

